

vtech[®]
Baby

Parent's Guide

Touch & Discover Sensory Turtle™



INTRODUCTION

Thank you for purchasing the **VTech® Touch & Discover Sensory Turtle™**. This cute plush toy converts from a turtle to a ball. The large light-up button on the turtle's shell introduces colors and numbers and plays sing-along songs and melodies. Wiggle the turtle to trigger the motion sensor to hear a variety of playful sounds. The electronic module can be easily removed to hand wash the turtle.

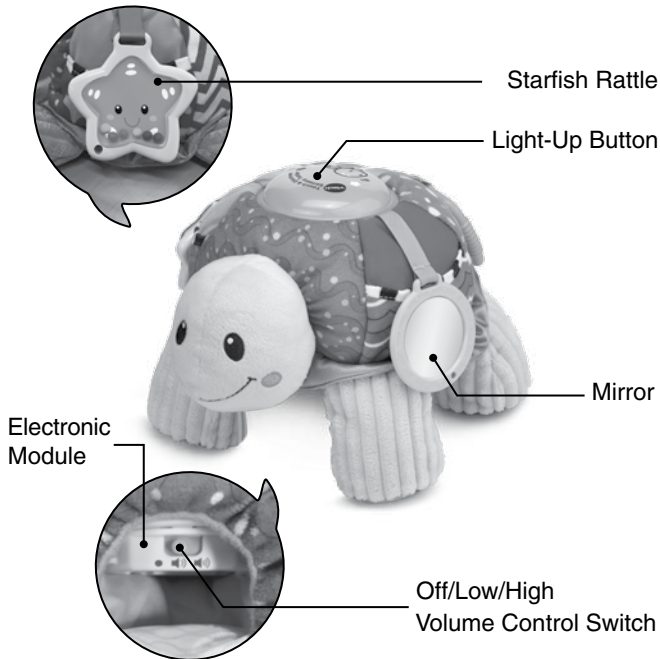

INCLUDED IN THIS PACKAGE

- One Touch & Discover Sensory Turtle™
- One parent's guide

WARNING: All packing materials, such as tape, plastic sheets, packaging locks, removable tags, cable ties and packaging screws are not part of this toy, and should be discarded for your child's safety.

NOTE: Please keep this parent's guide as it contains important information.

ATTENTION : Pour la sécurité de votre enfant, débarrassez-vous de tous les produits d'emballage tels que rubans adhésifs, feuilles de plastique, attaches, étiquettes et vis d'emballage. Ils ne font pas partie du jouet.

NOTE : Il est conseillé de conserver ce guide des parents car il comporte des informations importantes.

Please cut the plastic loop between the turtle's head and the shell, and remove the cardboard piece from inside the turtle.

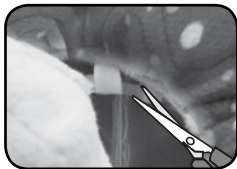

GETTING STARTED

BATTERY INSTALLATION

1. Make sure the unit is turned **OFF**.
2. Locate the battery cover on the electronic module inside the turtle. Use a screwdriver to loosen the screws.
3. Install 2 new AAA (AM-4/LR03) batteries following the diagram inside the battery box. (The use of new alkaline batteries is recommended for maximum performance.)
4. Replace the battery cover and tighten the screws to secure.

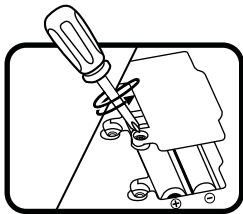

BATTERY NOTICE

- Use new alkaline batteries for maximum performance.
- Use only batteries of the same or equivalent type as recommended.
- Do not mix different types of batteries: alkaline, standard (carbon-zinc) or rechargeable, or new and used batteries.
- Do not use damaged batteries.
- Insert batteries with the correct polarity.
- Do not short-circuit the battery terminals.
- Remove exhausted batteries from the toy.
- Remove batteries during long periods of non-use.
- Do not dispose of batteries in fire.
- Do not charge non-rechargeable batteries.
- Remove rechargeable batteries from the toy before charging (if removable).
- Rechargeable batteries are only to be charged under adult supervision.

WASHING INSTRUCTIONS

NOTE: Please remove the electronic module from the turtle before washing.

1. To remove the **Electronic Module** from inside the turtle, make sure that the turtle's head is in the outward position. Locate the **Electronic Module** inside the main body. Pull down on the **Electronic Module** to detach it from the holder.



2. Remove the **Mirror** and **Starfish Rattle** from the ribbon tags before washing. Follow the washing instructions on the plush tag.

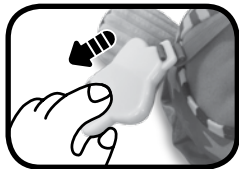

3. To reinsert the **Electronic Module**, please align the small blue button on the back of the **Electronic Module** with the slot on the holder inside the turtle's shell. Push the **Electronic Module** to the holder inside the shell. When the **Electronic Module** is inserted correctly, you will hear it click into place.



PRODUCT FEATURES

1. Off/Low/High Volume Control Switch

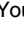
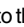
To turn the unit **ON**, slide the **Off/Low/High Volume Control Switch** to the **Low Volume** () or **High Volume** () position. You will hear a song, a phrase and a short tune. To turn the unit **OFF**, slide the **Off/Low/High Volume Control Switch** to the **OFF** () position.

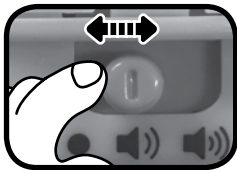

2. Automatic Shut Off

To preserve battery life, the **Touch & Discover Sensory Turtle™** will automatically power down after approximately 2 minutes without input. The unit can be turned on again by pressing the **Light-Up Button**.

NOTE: If the unit repeatedly powers down when playing, we recommend changing the batteries.

The unit is in try-me mode in the package. To access the regular play mode, please turn the unit off and then on again.

ACTIVITIES

1. Light-Up Button

Press the **Light-Up Button** to hear about colors and numbers, and listen to songs, playful sounds and melodies.



2. Motion Sensor

Wiggle, roll or shake the turtle to activate the **Motion Sensor** and hear a variety of playful sounds and short tunes. If a melody is playing, activate the **Motion Sensor** to hear fun sounds play over the melody.

SONG LYRICS

SONG 1

I'm a soft turtle,
Tuck me in and I can roll.
I'm not too big, but I'm not too small,
I'm just the right size for you to hold.

SONG 2

I'm a turtle, I'm a turtle,
I move slow, I move slow.
Turn me into a ball, turn me into a ball,
I will roll, I will roll.

SONG 3

Hi little baby, explore with me.
Let's go on a crawling journey.
Follow my steps now 1-2-3,
There's so much for us to see.

SONG 4

Crawling, rolling, playing with you.
Hiding, seeking, peek-a-boo.
Red and yellow, and green and blue,
I'm peeking out of my shell to play with you!

MELODY LIST

1. Take Me Out to the Ball Game
2. The Teddy Bears' Picnic
3. Yankee Doodle
4. Boys and Girls Go Out to Play
5. Goosey Goosey Gander
6. Camptown Races
7. The Mexican Hat Dance
8. On Top of Old Smokey
9. One Man Went to Mow
10. Peter, Peter Pumpkin Eater
11. She'll Be Coming 'Round the Mountain
12. Where Has My Little Dog Gone?
13. When the Saints Go Marching In
14. Turkey in the Straw
15. Froggie Went A-Courting

CARE & MAINTENANCE

1. Keep the unit clean by wiping it with a slightly damp cloth.
2. Keep the unit out of direct sunlight and away from any direct heat sources.
3. Remove the batteries when the unit is not in use for an extended period of time.
4. Do not drop the unit on a hard surface and do not expose the unit to excess moisture.

TROUBLESHOOTING

If for some reason the program/activity stops working, please follow these steps:

1. Turn the unit **OFF**.
2. Interrupt the power supply by removing the batteries.
3. Let the unit stand for a few minutes, then replace the batteries.
4. Turn the unit back **ON**. The unit will now be ready to play again.
5. If the unit still does not work, replace with an entire set of new batteries.

If the problem persists, please call our Consumer Services Department at 1-800-521-2010 in the U.S. or 1-877-352-8697 in Canada, or by going to our website at vtechkids.com and filling out our Contact Us form located under the Customer Support link. A service representative will be happy to help you.

IMPORTANT NOTE:

Creating and developing **VTech**[®] products is accompanied by a responsibility that we at **VTech**[®] take very seriously. We make every effort to ensure the accuracy of the information, which forms the value of our products. However, errors sometimes can occur. It is important for you to know that we stand behind our products and encourage you to call our Consumer Services Department at 1-800-521-2010 in the U.S. or 1-877-352-8697 in Canada, or by going to our website at vtechkids.com and filling out our Contact Us form located under the Customer Support link with any problems and/or suggestions that you might have. A service representative will be happy to help you.

Note:

This equipment has been tested and found to comply with the limits for a Class B digital device, pursuant to Part 15 of the FCC Rules. These limits are designed to provide reasonable protection against harmful interference in a residential installation. This equipment generates, uses and can radiate radio frequency energy and, if not installed and used in accordance with the instructions, may cause harmful interference to radio communications. However, there is no guarantee that interference will not occur in a particular installation. If this equipment does cause harmful interference to radio or television reception, which can be determined by turning the equipment off and on, the user is encouraged to try to correct the interference by one or more of the following measures:

- Reorient or relocate the receiving antenna.
- Increase the separation between the equipment and receiver.
- Connect the equipment into an outlet on a circuit different from that to which the receiver is connected.
- Consult the dealer or an experienced radio/TV technician for help.

THIS DEVICE COMPLIES WITH PART 15 OF THE FCC RULES. OPERATION IS SUBJECT TO THE FOLLOWING TWO CONDITIONS:
(1) THIS DEVICE MAY NOT CAUSE HARMFUL INTERFERENCE, AND
(2) THIS DEVICE MUST ACCEPT ANY INTERFERENCE RECEIVED, INCLUDING INTERFERENCE THAT MAY CAUSE UNDESIRE OPERATION.

CAN ICES-3 (B)/NMB-3(B)

Caution: Changes or modifications not expressly approved by the party responsible for compliance could void the user's authority to operate the equipment.

**Visit our website for more
information about our products,
downloads, resources and more.**

vtechkids.com

Read our complete warranty policy online at
vtechkids.com/warranty

